

# Pyrolino

the outer comfort

USER MANUAL

English

CE

**Copyright © 2019, Axinar Inc.**

---

All rights reserved. No part of this publication may be reproduced, stored in a retrieval system, or transmitted, in any form, or by any means, mechanical, electronic, photocopying, recording, or otherwise, without the written permission of Axinar, Inc. No patent liability is assumed with respect to the use of the information contained herein. Moreover, the information contained in this manual is subject to change without notice. We have taken every precaution in the preparation of this manual; nevertheless, Axinar Inc. assumes no responsibility for errors or omissions, and we assume no liability for damages resulting from the use of the information contained in this publication.

## Thank you for purchasing Pyrolino portable stove!

This manual contains information about the proper and safe operation of Pyrolino.

Please read all the instructions carefully before using Pyrolino Portable Stove, even if you are familiar with the product. Failure to comply with the precautions and instructions provided with the stove can result in property loss or damage, serious bodily injury, or death. Only persons who can understand and follow the instructions should use this stove. This document was drafted by Axinar in accordance with the European Standard EN 1860-1:2013+A1:2017.

Keep the manual for future reference. You can find an electronic copy of this manual and other useful information on our website. **[www.pyrolino.com/manuals](http://www.pyrolino.com/manuals)**.

If you have any concerns or queries about Pyrolino that are not included in this manual, please visit our website, **[www.pyrolino.com/contact/](http://www.pyrolino.com/contact/)** and send your comments to our Customer Service Department, by using the contact form.

Before first use, check out our warranty policy at **[www.pyrolino.com/warranty/](http://www.pyrolino.com/warranty/)**



For faster warranty claims, customer service and updates about Pyrolino, don't forget to register your product on **[www.pyrolino.gr/product-registration/](http://www.pyrolino.gr/product-registration/)**



### NOTE

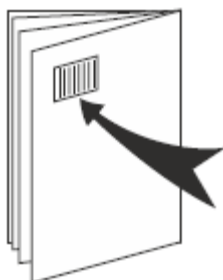

Find your Product Serial Number at the sticker on the back cover of this manual.

## Join Pyrolino Community



### We would love to hear from you!

If you could spare a few minutes to let us know what we're doing right and what we can improve, please send us an email at [support@pyrolino.com](mailto:support@pyrolino.com) using "Feedback" as a subject.

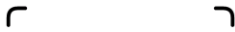

**PYROLINOSTOVE**

Share your Pyrolino stories on our Instagram account using **#Pyrolino** for a chance to get featured.



# **CONTENTS**

<b>WARNING</b> .....	6
<b>DESIGN</b> .....	7
<b>COMPONENTS</b> .....	7
<b>INSTRUCTIONS</b> .....	8
<b>SAFE OPERATION</b> .....	10
<b>Before Use</b> .....	10
<b>During Use</b> .....	10
<b>After use</b> .....	10
<b>Repair</b> .....	10
<b>FUEL CONSUMPTION</b> .....	11

**⚠ WARNING!**



The portable pellet stove will become very hot, do not move it during operation!



Do not use spirit, petrol or any other liquid accelerant for lighting or re-lighting! Use only firelighters complying to EN 1860-3.



Do not use indoors! Do not use the portable pellet stove in a confined and/or habitable place without fresh air. Danger of monoxide poisoning fatality.



Do not leave Pyrolino unattended! Close adult supervision is necessary when Pyrolino is on use.



Do not use Pyrolino for other than the intended use!



Keep children and pets away!



Follow all local fire-making regulations!



Do not use the stove when parts of it are damaged or worn out!

**IMPORTANT!**

- This appliance can be used with pellet, wood, woodchips, biomass, kernels, pine nuts, corn and common coal.
- This appliance can be used as an oven, a barbecue, a lighting and a heating body.
- For better & longer service, keep the stove clean at all times.

## DESIGN

Model or Type	Stainless Steel Portable Pellet Stove
Nominal Thermal Load	2 – 3.5 kW
Capacity	Up to 1,5 hours
Dimensions	25cm x 13cm x 13cm / 9.8" x 5.1" x 5.1"
Weight	1700gr/ 3.75 lb.
Guarantee	1 year
Fuel	Biomass (pellet, woodchips, wood, kernel, pine nuts, coal)
Accessories Available	Barbeque grate, Oven, Lighting body

## COMPONENTS

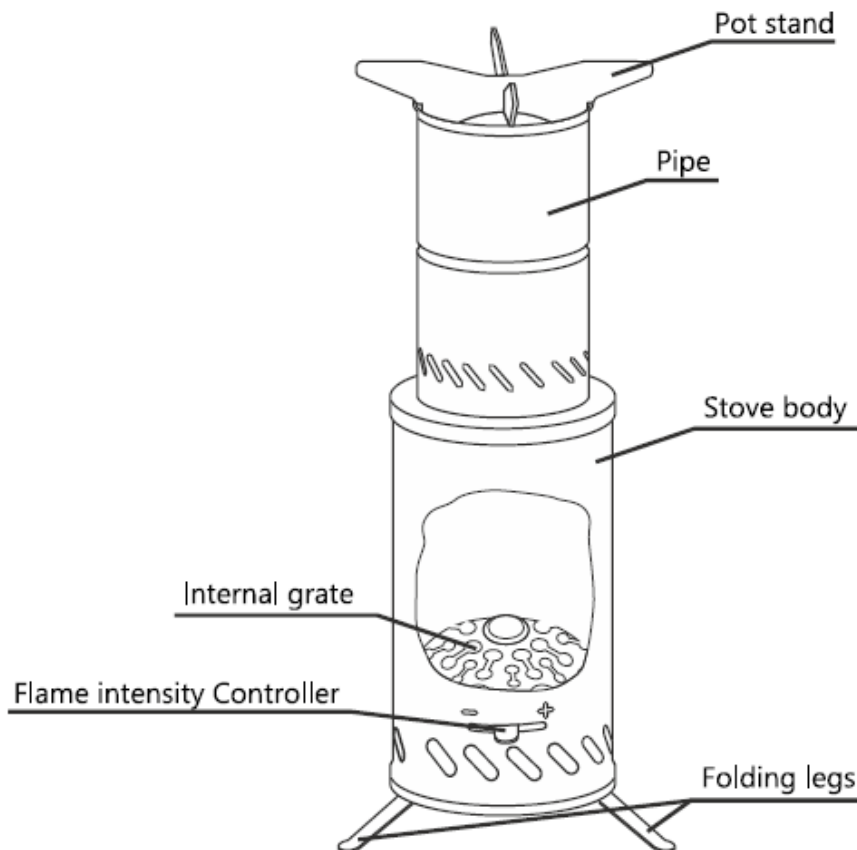

## INSTRUCTIONS

### HOW TO ASSEMBLE AND FIRE UP YOUR PYROLINO

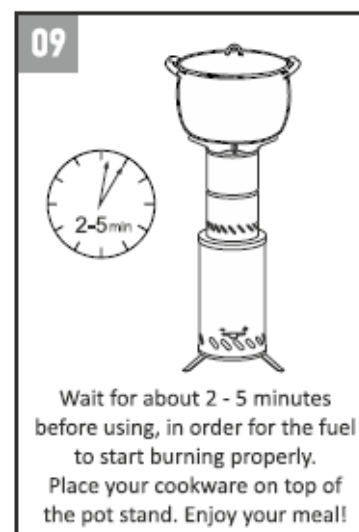
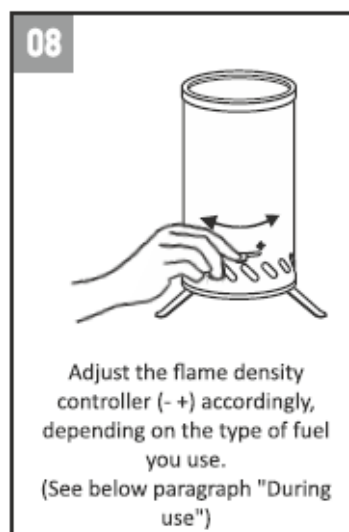
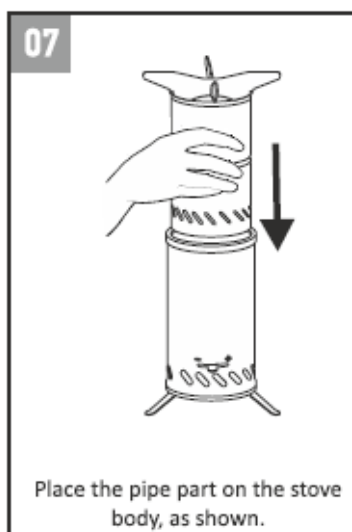
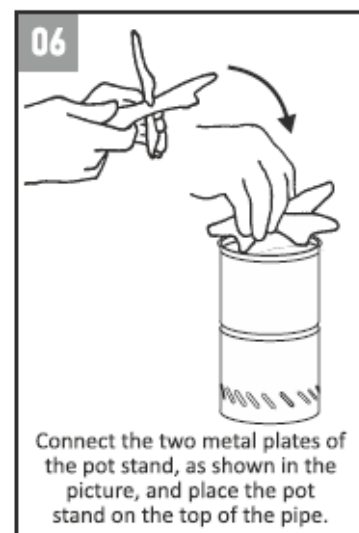
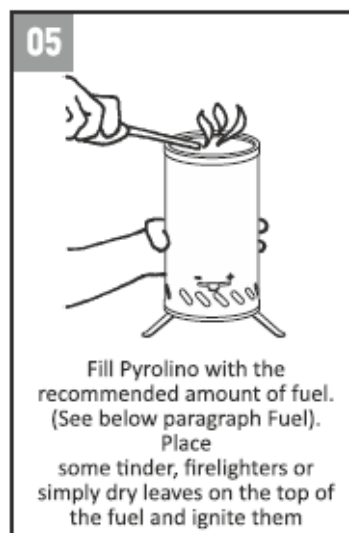
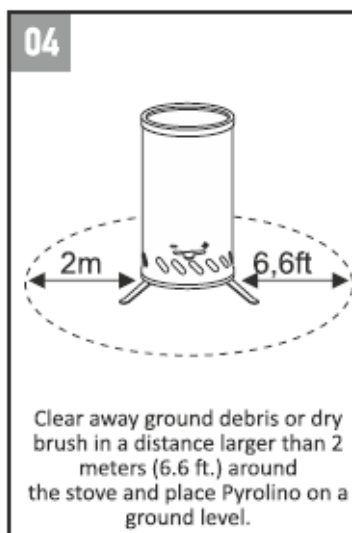
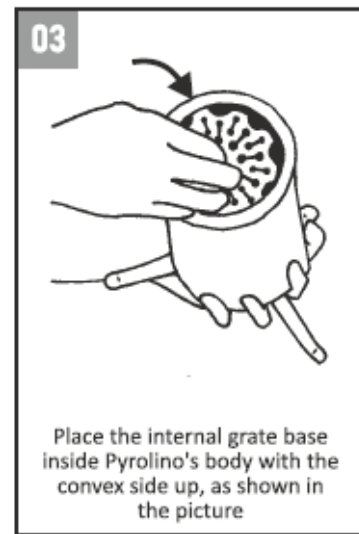
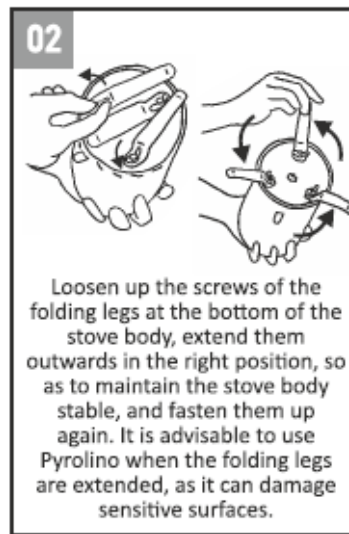
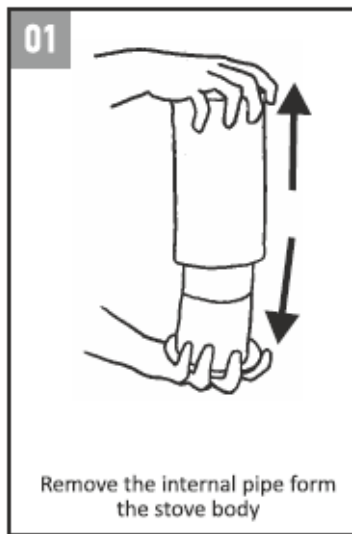



## HOW TO DISASSEMBLE AND STORE YOUR PYROLINO

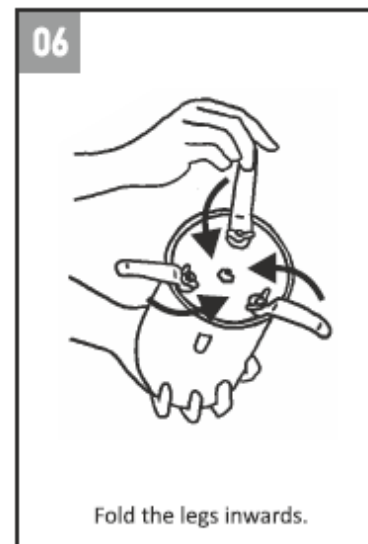
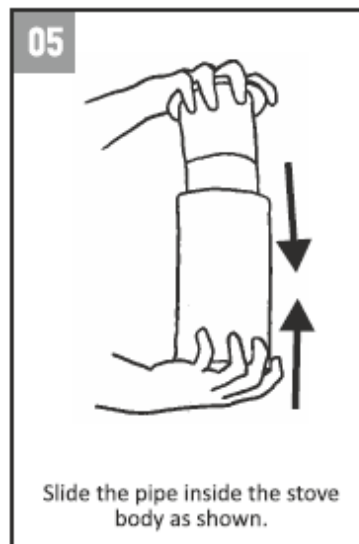
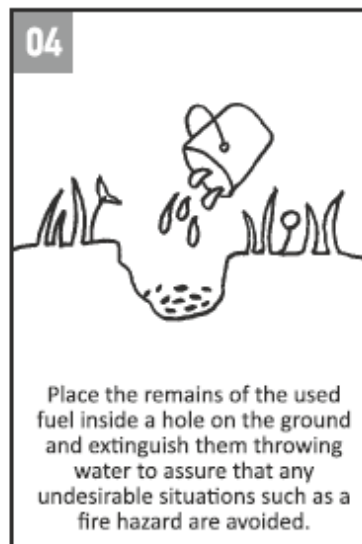
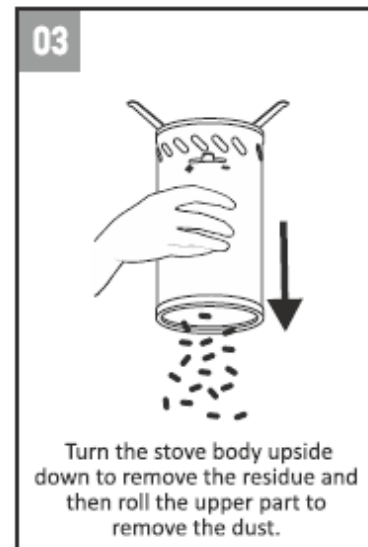
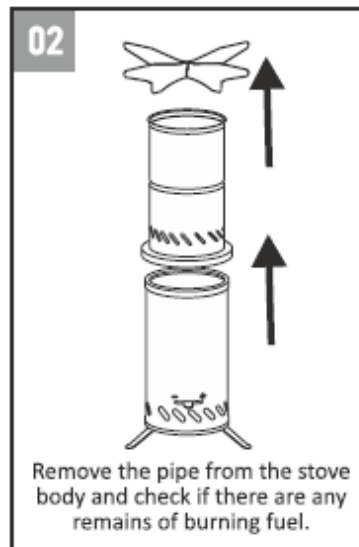
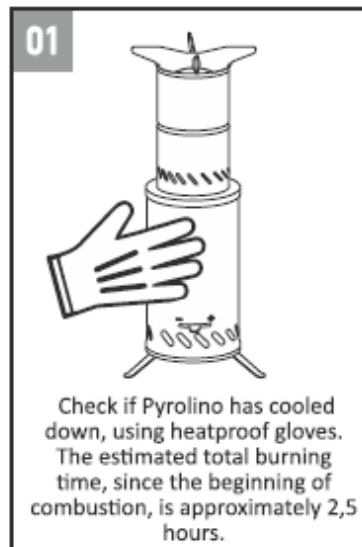

## SAFE OPERATION

### BEFORE USE

- A. After unpacking and prior to use, Pyrolino must be positioned correctly on a secure level base. Avoid using Pyrolino when it's windy, because it can cause instability.
- B. Ensure that no combustible materials, inflammable substances or explosive objects are kept in a distance smaller than 2 meters (6.6 ft.) from the Stove.
- C. Wait 2 – 5 minutes for Pyrolino to maintain a stable flame. Do not cook before the fuel has a coating of ash to prevent smoke production and discoloring of the utensils.

### DURING USE

- A. While in use & immediately after use, do not touch the stove as it gets very hot.
- B. Do not leave the stove unattended. Close supervision is necessary when Pyrolino is on use.
- C. Adjust the flame density controller (- +) accordingly, depending on the type of fuel you use. The flame density controller adjusts the amount of air supply into Pyrolino's combustion chamber, thus controlling the density of the flame. Reaching (+) supplies Pyrolino with more air, while (-) supplies with less air. Typically, denser fuel (ex. corn) requires more air to start burning and reach maximum efficiency.
- D. Use small or medium size cookware. The metal base can accommodate up to 5 kg (11 lbs.) of weight.
- E. Ensure the cookware is stable when in use.
- F. At the end of the combustion cycle, Pyrolino starts burning the remaining coal, produced from the first phase of natural combustion. As a result, the flame will gradually become blue. This is an indicator of the CO combustion.
- G. Always wait Pyrolino to cool down first, before refilling. Do not refill while Pyrolino is on use.

### AFTER USE

- A. Before cleaning, wait for Pyrolino to cool down, and then, remove the residue.
- B. Do not pour water in the stove. It causes the production of clinker and damages its components.
- C. Do not use hard scrub brush or power type cleanser as it may cause deformations on the metal surface.

### REPAIR

Never attempt to dismantle, repair or modify Pyrolino on your own. Doing so may cause abnormal operation or result in danger. Please contact Pyrolino Customer Service to have it addressed.

## NOTICE

The manufacturer cannot be held liable for damage to people or items caused by failure to observe the above instructions, by interference with any part of the appliance or by the use of non-original accessories.

## FUEL CONSUMPTION

- A. It is advisable to use dry fuel; green ones may cause smoking.
- B. Avoid overstuffing, in order to guarantee sufficient air flow (Figures 1 & 2).

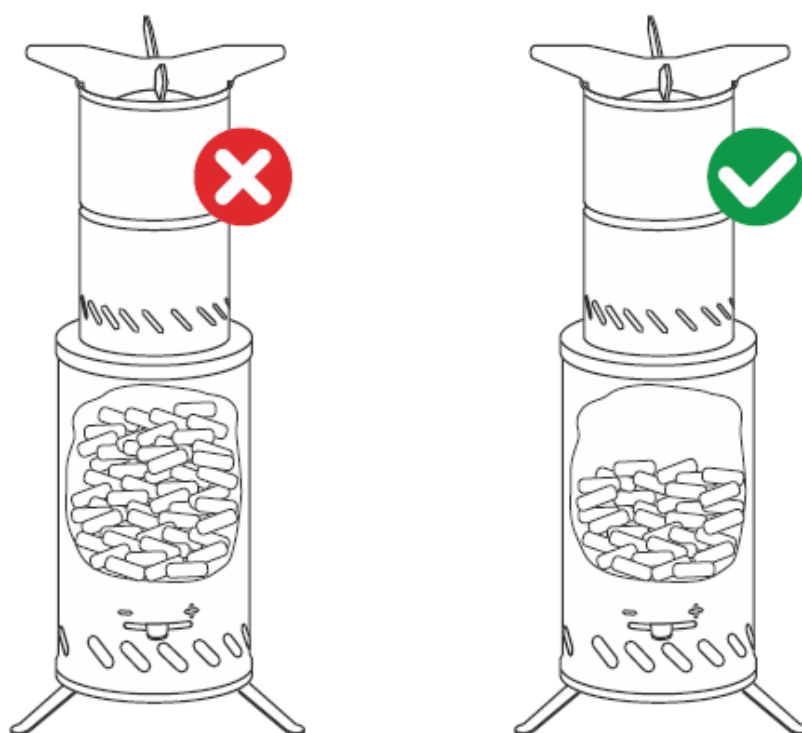

## NOTICE

The manufacturer cannot be held liable for damage to people or items caused by the consumption of unapproved fuel.

**Pyrolino**  
the outer comfort